

RESOLUTION NO. 937

A RESOLUTION INITIATING THE VACATION OF PUBLIC UTILITY EASEMENTS IN THE WILSONVILLE MEADOWS SUBDIVISION, LOTS 52 THROUGH 112, AND SETTING A PUBLIC HEARING DATE

WHEREAS, a city governing body may initiate vacation proceedings as authorized by ORS 271.080 upon reception of a petition from the property owner(s); and

WHEREAS, the ROBERT RANDALL COMPANY has filed a petition and a request to vacate real property described in Exhibits "A" and "B" which are attached hereto; and

WHEREAS; the ROBERT RANDALL COMPANY has previously deposited monies with the City that was sufficient to cover the cost of publication, posting and other expenses; and

WHEREAS; the Wilsonville City Council finds that this is the appropriate time to address Robert Randall's request.

NOW, THEREFORE, THE CITY OF WILSONVILLE RESOLVES AS FOLLOWS:

- (1) The City Recorder shall publish and post the public notice required by ORS 271.110 - Notice of Public Hearing; and
- (2) A public hearing shall be scheduled for August 3, 1992 at a regular meeting of the Wilsonville City Council at 7:00 p.m. at the Wilsonville Community Development Hearings Room.

ADOPTED by the City Council of the City of Wilsonville at a regular meeting thereof the 20th day of July, 1992 and filed with the Wilsonville City Recorder this same day.

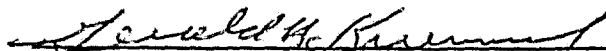

GERALD A. KRUMMEL, Mayor

ATTEST:

Vera A. Rojas

VERA A. ROJAS, CMC/AAE, City Recorder

SUMMARY of Votes:

Mayor Krummel	<u>AYE</u>
Councilor Chandler	<u>AYE</u>
Councilor Carter	<u>AYE</u>
Councilor Lehan	<u>AYE</u>
Councilor Van Eck	<u>ABSENT</u>

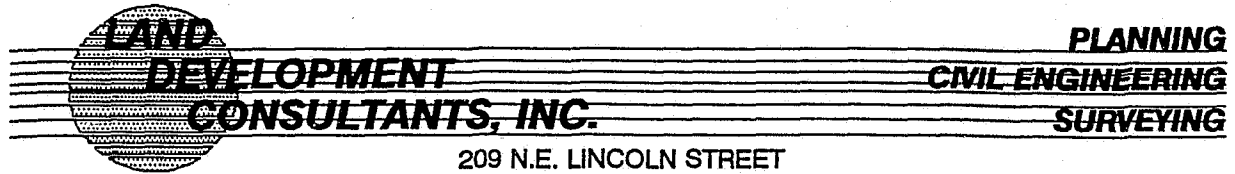

209 N.E. LINCOLN STREET
HILLSBORO, OREGON 97124
PHONE: (503) 648-4061 or FAX: (503) 681-7646

Ryan O'Brien, Planner
Chris Bedsaul, Planner
John Darling, Planner, AICP
Paul Sedoruk, Designer

J.H. (Dutch) Sigmund, PLS, PE
H.R. (Hugh) O'Reilly, PE
Richard Girard, PLS, CET
Mike Webber, Project Manager

Bob Oquist, PLS
Duane Marx, Survey Manager
Jerry Kraemer, PLS (Wisc.)
Dave Moore, PLS (Colo.)

Vacation of 1.00 foot lying interior to the lot of that certain 6.00 foot wide public utility easement along the side and rear lot lines of Lots 52 through 112 of the duly recorded plat of "Wilsonville Meadows No. 2," Clackamas County records, reducing and maintaining said 6.00 foot wide easement to 5.00 foot wide along all side and rear lot lines of said Lots 52 through 112, said plat.

wp131.parcel.565
10/26/90

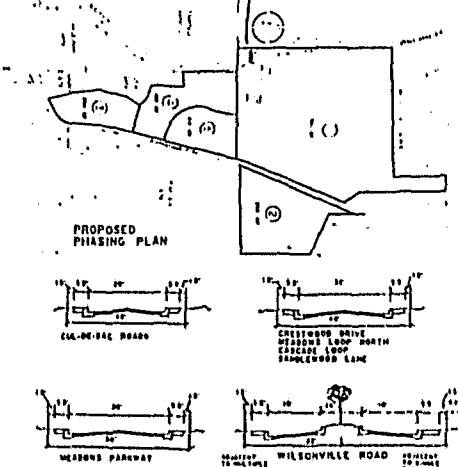
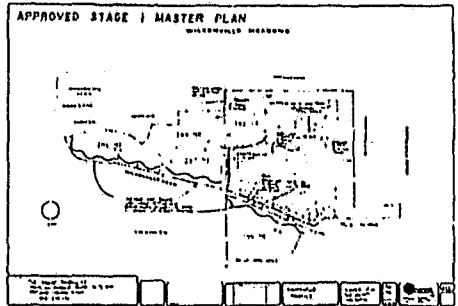
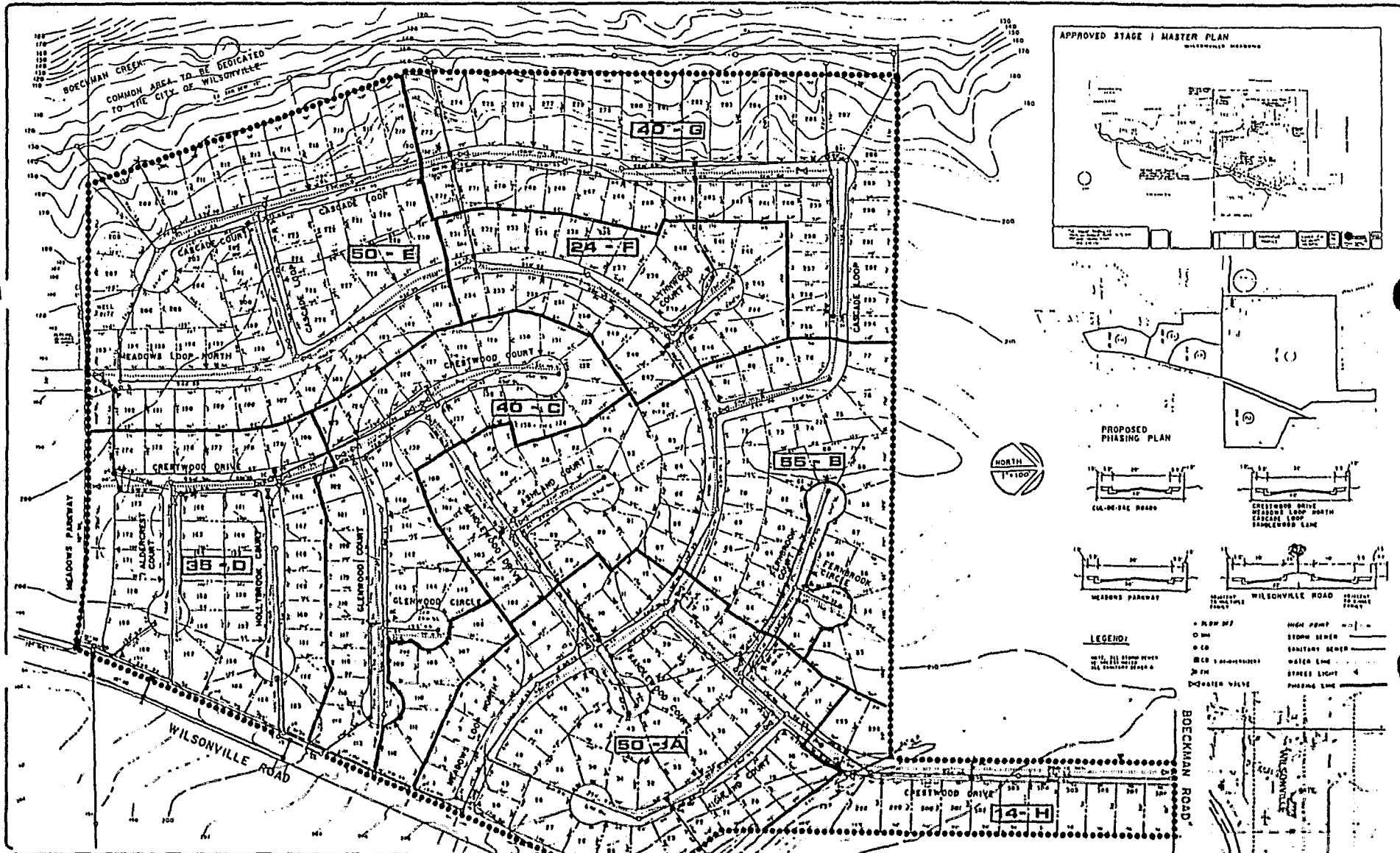

- LEGEND:**
- NEW SP
 - EX
 - 12" S&S
 - 18" S&S
 - 24" S&S
 - 30" S&S
 - 36" S&S
 - 42" S&S
 - 48" S&S
 - 54" S&S
 - 60" S&S
 - 66" S&S
 - 72" S&S
 - 78" S&S
 - 84" S&S
 - 90" S&S
 - 96" S&S
 - 102" S&S
 - 108" S&S
 - 114" S&S
 - 120" S&S
 - 126" S&S
 - 132" S&S
 - 138" S&S
 - 144" S&S
 - 150" S&S
 - 156" S&S
 - 162" S&S
 - 168" S&S
 - 174" S&S
 - 180" S&S
 - 186" S&S
 - 192" S&S
 - 198" S&S
 - 204" S&S
 - 210" S&S
 - 216" S&S
 - 222" S&S
 - 228" S&S
 - 234" S&S
 - 240" S&S
 - 246" S&S
 - 252" S&S
 - 258" S&S
 - 264" S&S
 - 270" S&S
 - 276" S&S
 - 282" S&S
 - 288" S&S
 - 294" S&S
 - 300" S&S
 - 306" S&S
 - 312" S&S
 - 318" S&S
 - 324" S&S
 - 330" S&S
 - 336" S&S
 - 342" S&S
 - 348" S&S
 - 354" S&S
 - 360" S&S
 - 366" S&S
 - 372" S&S
 - 378" S&S
 - 384" S&S
 - 390" S&S
 - 396" S&S
 - 402" S&S
 - 408" S&S
 - 414" S&S
 - 420" S&S
 - 426" S&S
 - 432" S&S
 - 438" S&S
 - 444" S&S
 - 450" S&S
 - 456" S&S
 - 462" S&S
 - 468" S&S
 - 474" S&S
 - 480" S&S
 - 486" S&S
 - 492" S&S
 - 498" S&S
 - 504" S&S
 - 510" S&S
 - 516" S&S
 - 522" S&S
 - 528" S&S
 - 534" S&S
 - 540" S&S
 - 546" S&S
 - 552" S&S
 - 558" S&S
 - 564" S&S
 - 570" S&S
 - 576" S&S
 - 582" S&S
 - 588" S&S
 - 594" S&S
 - 600" S&S
 - 606" S&S
 - 612" S&S
 - 618" S&S
 - 624" S&S
 - 630" S&S
 - 636" S&S
 - 642" S&S
 - 648" S&S
 - 654" S&S
 - 660" S&S
 - 666" S&S
 - 672" S&S
 - 678" S&S
 - 684" S&S
 - 690" S&S
 - 696" S&S
 - 702" S&S
 - 708" S&S
 - 714" S&S
 - 720" S&S
 - 726" S&S
 - 732" S&S
 - 738" S&S
 - 744" S&S
 - 750" S&S
 - 756" S&S
 - 762" S&S
 - 768" S&S
 - 774" S&S
 - 780" S&S
 - 786" S&S
 - 792" S&S
 - 798" S&S
 - 804" S&S
 - 810" S&S
 - 816" S&S
 - 822" S&S
 - 828" S&S
 - 834" S&S
 - 840" S&S
 - 846" S&S
 - 852" S&S
 - 858" S&S
 - 864" S&S
 - 870" S&S
 - 876" S&S
 - 882" S&S
 - 888" S&S
 - 894" S&S
 - 900" S&S
 - 906" S&S
 - 912" S&S
 - 918" S&S
 - 924" S&S
 - 930" S&S
 - 936" S&S
 - 942" S&S
 - 948" S&S
 - 954" S&S
 - 960" S&S
 - 966" S&S
 - 972" S&S
 - 978" S&S
 - 984" S&S
 - 990" S&S
 - 996" S&S
 - 1002" S&S
 - 1008" S&S
 - 1014" S&S
 - 1020" S&S
 - 1026" S&S
 - 1032" S&S
 - 1038" S&S
 - 1044" S&S
 - 1050" S&S
 - 1056" S&S
 - 1062" S&S
 - 1068" S&S
 - 1074" S&S
 - 1080" S&S
 - 1086" S&S
 - 1092" S&S
 - 1098" S&S
 - 1104" S&S
 - 1110" S&S
 - 1116" S&S
 - 1122" S&S
 - 1128" S&S
 - 1134" S&S
 - 1140" S&S
 - 1146" S&S
 - 1152" S&S
 - 1158" S&S
 - 1164" S&S
 - 1170" S&S
 - 1176" S&S
 - 1182" S&S
 - 1188" S&S
 - 1194" S&S
 - 1200" S&S
 - 1206" S&S
 - 1212" S&S
 - 1218" S&S
 - 1224" S&S
 - 1230" S&S
 - 1236" S&S
 - 1242" S&S
 - 1248" S&S
 - 1254" S&S
 - 1260" S&S
 - 1266" S&S
 - 1272" S&S
 - 1278" S&S
 - 1284" S&S
 - 1290" S&S
 - 1296" S&S
 - 1302" S&S
 - 1308" S&S
 - 1314" S&S
 - 1320" S&S
 - 1326" S&S
 - 1332" S&S
 - 1338" S&S
 - 1344" S&S
 - 1350" S&S
 - 1356" S&S
 - 1362" S&S
 - 1368" S&S
 - 1374" S&S
 - 1380" S&S
 - 1386" S&S
 - 1392" S&S
 - 1398" S&S
 - 1404" S&S
 - 1410" S&S
 - 1416" S&S
 - 1422" S&S
 - 1428" S&S
 - 1434" S&S
 - 1440" S&S
 - 1446" S&S
 - 1452" S&S
 - 1458" S&S
 - 1464" S&S
 - 1470" S&S
 - 1476" S&S
 - 1482" S&S
 - 1488" S&S
 - 1494" S&S
 - 1500" S&S

THE ROBERT RANDALL CO.
 9500 SW BARBUR BLVD SUITE 300
 PORTLAND, OREGON 97219
 503 - 245-1131

NO.	REVISION	DATE
1	INITIALS AND DATES	2-15-88
2	DATE AND SCALE CHANGE	2-22-88

PROJECT
WILSONVILLE MEADOWS
 300 SINGLE FAMILY LOTS

PHASE I
PRELIMINARY PLAT

DEVELOPMENT
RESULTS INC.
 1000 SW 10TH AVENUE
 PORTLAND, OREGON 97204
 503-245-1131

EXHIBIT "B"

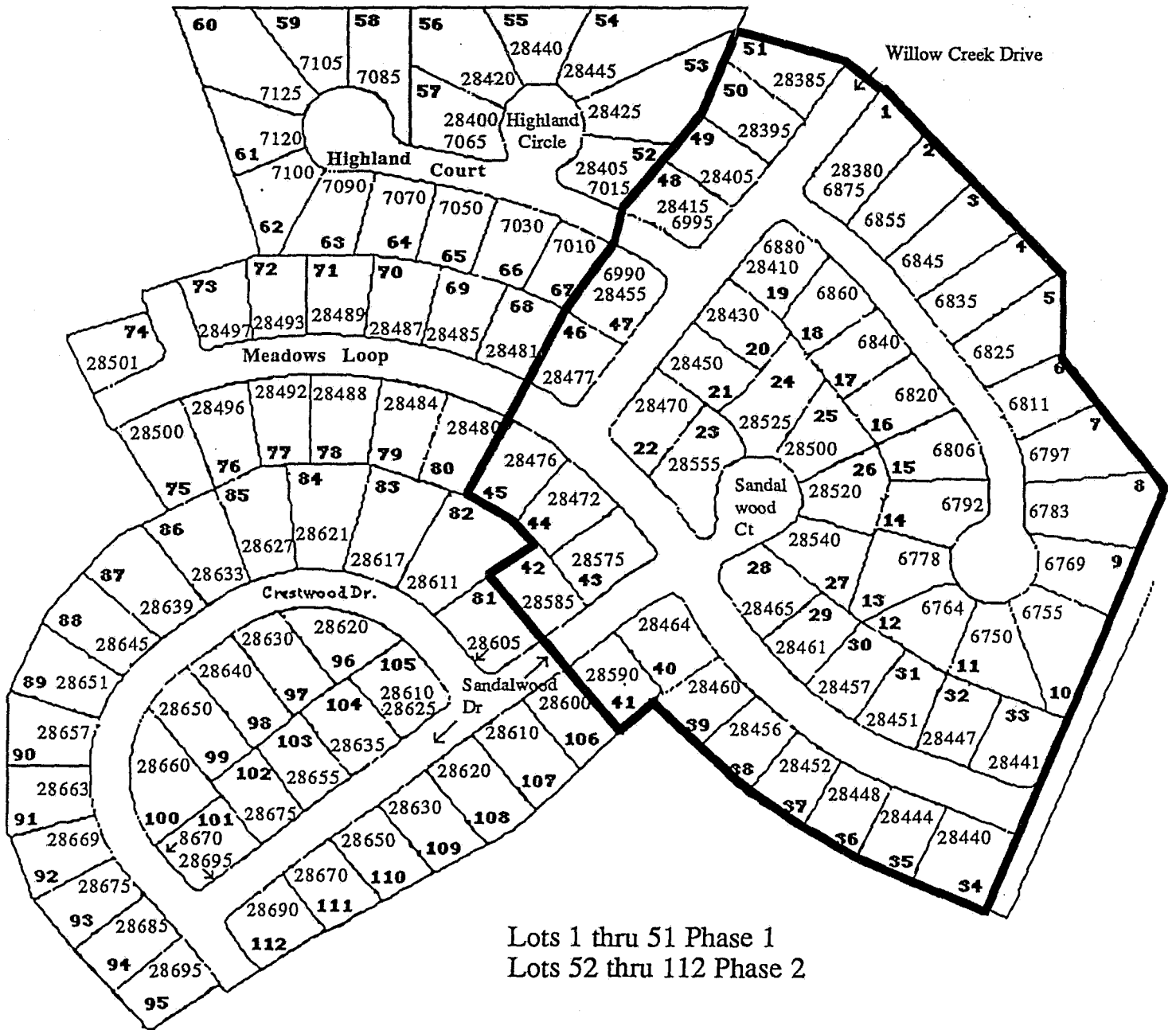

 NORTH
 No Scale

Wilsonville Meadows Phase 1 & 2 Addresses and Lot Numbers